

BOILER ROOM SYSTEM

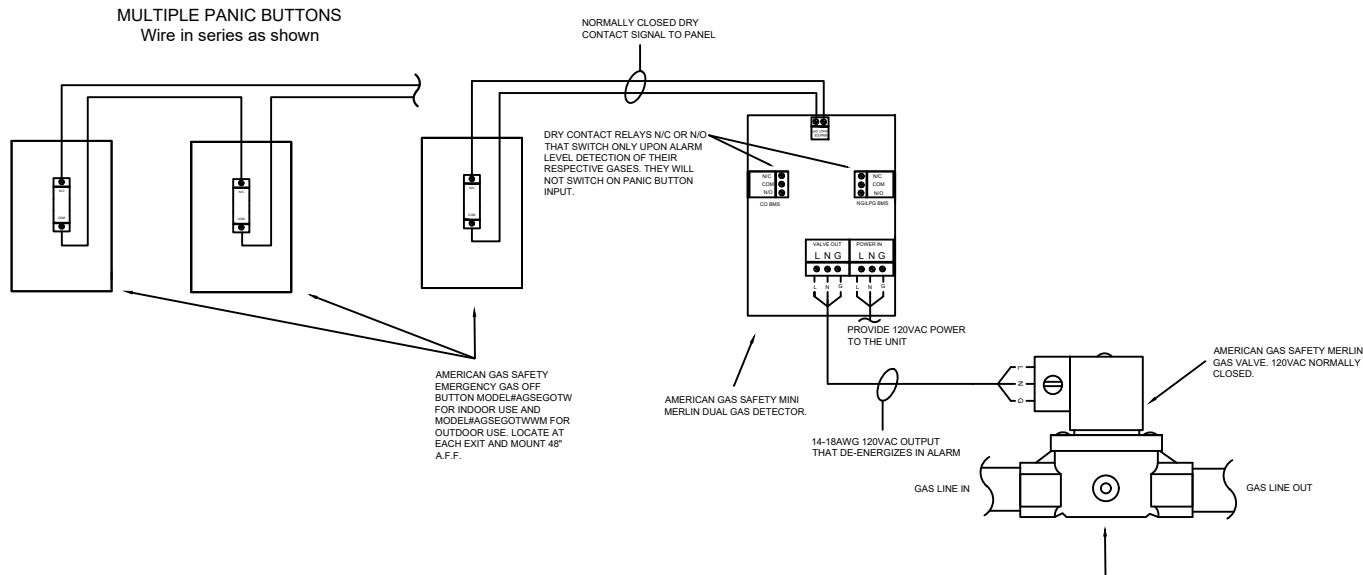
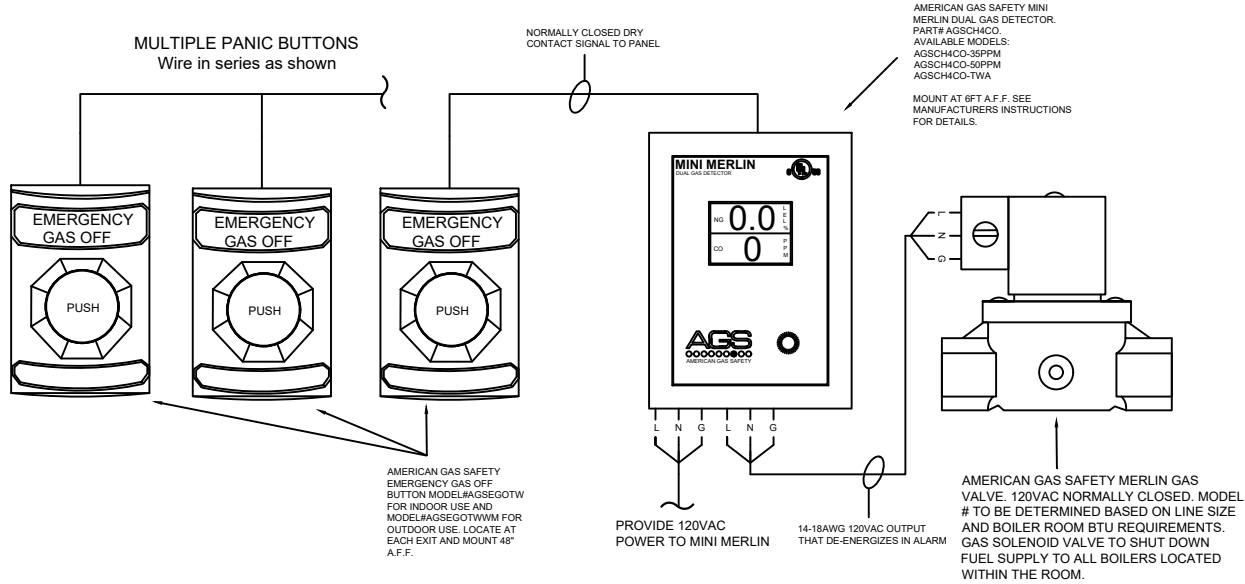

- SEQUENCE OF OPERATION:
1. NORMAL OPERATION: WHEN THE MINI MERLIN DETECTOR IS POWERED AND GAS LEVELS ARE BELOW THE ALARM THRESHOLD, THE 120VAC OUTPUT WILL BE CONTINUOUSLY ENERGIZING THE NORMALLY CLOSED SOLENOID VALVE. UNDER THIS CONDITION, THE VALVE WILL BE OPEN, ALLOWING GAS TO FLOW.
 2. ALARM CONDITION: WHEN CARBON MONOXIDE OR NATURAL GAS LEVELS SURPASS THE MINI MERLIN'S ALARM THRESHOLD, THE 120VAC OUTPUT WILL DE-ENERGIZE CAUSING THE NORMALLY CLOSED GAS VALVE TO CLOSE.
 3. PANIC BUTTON INPUT: WHEN THE EMERGENCY PANIC BUTTON IS PRESSED, THE VALVE OUTPUT WILL BE DE-ENERGIZED, CAUSING THE VALVE TO CLOSE.
 4. MANUAL RESET: UNDER ANY ALARM OR PANIC BUTTON CONDITION, A MANUAL RESET WILL BE REQUIRED TO RETURN TO NORMAL OPERATION.
 5. ALARM LEVELS: 35PPM CARBON MONOXIDE AND 10%LEL COMBUSTIBLE GAS.
 6. PRE-ALARM LEVELS: 35PPM CARBON MONOXIDE AND 8%LEL COMBUSTIBLE GAS.

AMERICAN GAS SAFETY MERLIN GAS VALVE. 120VAC NORMALLY CLOSED. MODEL # TO BE DETERMINED BASED ON LINE SIZE AND BOILER ROOM BTU REQUIREMENTS. GAS SOLENOID VALVE TO SHUT DOWN FUEL SUPPLY TO ALL BOILERS LOCATED WITHIN THE ROOM.