



Mini Merlin Kitchens

Emergency Gas Shutdown With Gas Detection For Commercial Kitchens

Partcode:
 AGSCH4CO-TWA (Methane)
 AGSLPGCO-TWA (LPG)

Protect Life & Building



Automatic Emergency Gas Shutdown

Automatic gas supply shutdown in alarm i.e. gas detected, emergency panic & fire alarm activation



Manual Emergency Gas Shutdown

Use with a twist release panic button to manually shut off the gas supply in emergency



Manual Reset

Touch button for manual reset after an alarm state or upon start-up



BMS & Fire Panel Connectivity

Outputs available to BMS systems via the controllers dry contacts



Plug & Play

Pre-programmed inputs & outputs for fast and easy installation



UL Listed

UL 61010 Listed Controller
 UL 2075 sensor



Meets Code Requirements

Emergency gas shutdown and hazardous gas detection



Easy To Use

Clear TFT screen displays status indications & live gas detector values

Gas Detection

Two Stage Built-In Alarm With Automatic Shutdown

Gas Sensor	Alarm 1 - Pre Alarm Warning	Alarm 2 - Full Alarm	Life (Years)
Carbon Monoxide (CO)	> 20ppm	> 20ppm @ 2 hours / 50ppm @ 1 hour / 100ppm @ 10 minutes / 300ppm @ 1 minute	5
Methane / LPG	> 8% LEL	> 10% LEL	10

Other Shutdown Methods

Fire Alarm And Emergency Panic Button Input for Additional Shutdown Methods



**THE SMART
 AGS SOLUTION**

WISER AND SAFER CONDITION



Emergency Shutoff Buttons



Fire Alarm



Close a solenoid valve in alarm

INPUTS

Inputs from various devices will initiate an alarm condition, which will shut down connected devices

THE MINI MERLIN

Add in the Mini Merlin as a relay panel between your emergency shut off and fire alarm, and get the added benefits of combustible gas detection and simply the wiring.

OUTPUTS

Various built-in outputs allow the Mini Merlin to shut down devices

NORMALLY CLOSED DRY CONTACT INPUT

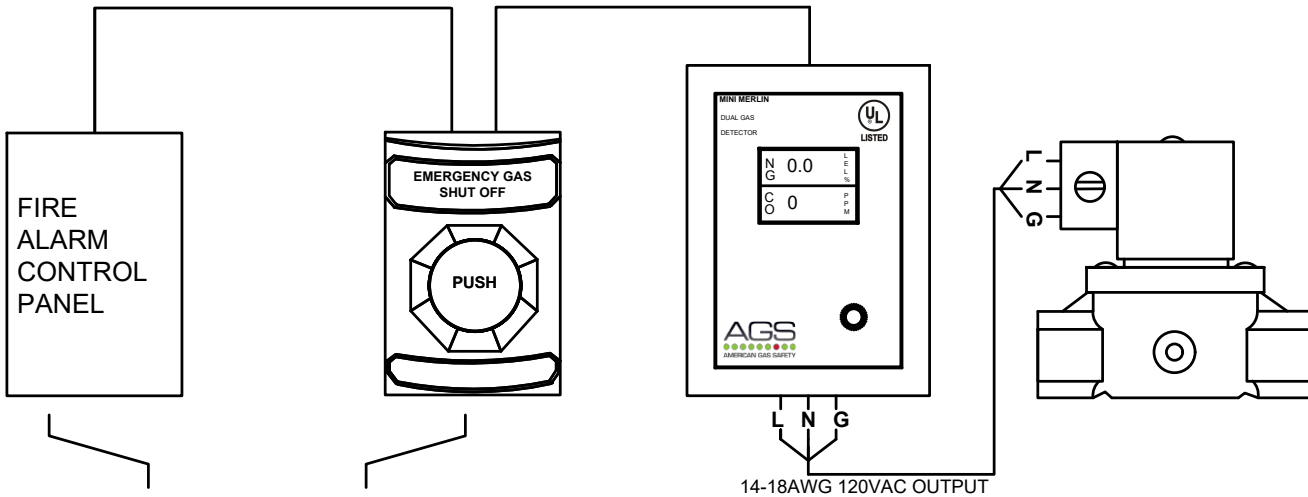

Fire Alarm

If the fire alarm is activated, the Mini Merlin will close the gas solenoid valve

Panic Button

If the emergency panic button activated, the Mini Merlin will close the gas solenoid valve

Gas Detection

When gases reach dangerous levels, it will automatically close the valve

Gas Solenoid Valve

120VAC normally closed gas solenoid valve for safety shut off

Find out more

American Gas Safety LLC

www.americangassafety.com

Head office: 6304 Benjamin Road, Suite 502, Tampa, FL 33634

Tel: (727) 608-4375

Email: info@americangassafety.com



**SIMPLE,
EFFICIENT &
RELIABLE**