

Gas Detection Sensor Nitrogen Dioxide & Carbon Monoxide



Key Features

- 12-24V power supply & detector chain data signal
- Up to 16 gas detector can be connected in a chain
- Modbus RTU compatibility
- Test button ensures all configured systems, alarms, indications and other external devices operate as intended
- Detector chain ID switches to allow the engineer to arrange each detector per zone
- Chain termination resistor switch used at the end of a chain loop
- End of Life and Fault notifications when the detector reaches its expected operational lifecycle (CO - 5 years / NO2 - 2 years)

Technical Specifications

Compatibility	ParkSafe Range
Visual Indicators	Power LED / Fault LED / Alarm LED
Modbus	RTU
Detector Chain Length	500 years max
Initial Stabilisation Time	60 Seconds Approximately
Power Input Voltage	12-24V / 7-30VDC
Consumption	15mA Max (24V)
Accuracy @ 25°C / 77°F	± 5%
Fuses	N/A
Operating Temp	32-122°F 30-85%RH Non-Condensing
Test Conditions	77° ± 41°F
Audible Alarm Buzzer (dB)	None

Gas Sensor Type	CO: Electro-Chemical	Measuring Range	CO: 10-10000ppm
	NO2: Electro-Chemical		NO2: 0-20ppm
Gas Level Pre-Alarm (parts per million)	CO: 25-100ppm	Gas Level Alarm (parts per million)	CO: >100ppm
	NO2: 0.7-2ppm		NO2: >2 ppm
Expected Sensor Life (from power up)	CO: 5 Years		
	NO2: 2 Years		
Dimensions (H x W x D)	5.51 x 3.74 x 1.18"		

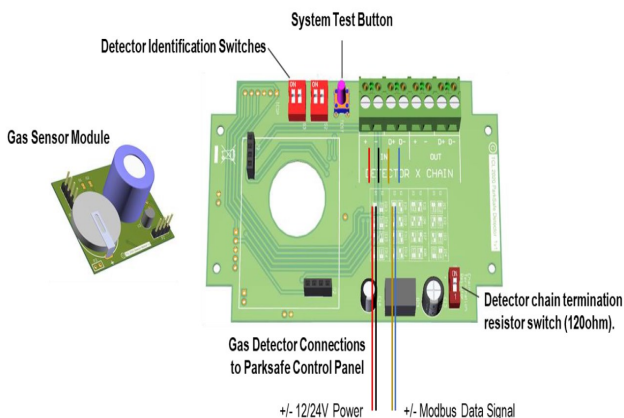

Typical Installation Arrangement

ParkSafe detectors are designed to connect to a centralised ParkSafe control panel. Use of sound strobes are highly recommended.

The ParkSafe control panel should be located outside of the hazardous area that they are monitoring. Easy accessibility is required both for status observation and alarm purposes.

Up to 16 detectors can be connected to the ParkSafe panel and chained up to approximately 500 yards from the panel (this varies depending on chain configuration, wire type and condition).

Carbon Monoxide (CO) Gas	Breathing Zone - 1700mm (5ft 6") from ground level
Nitrogen Dioxide (NO2) Gas	Low Level - 300mm (1ft) from ground level

Gas Safety Systems

Utility Control