

ASSEMBLY INSTRUCTIONS:

- A) Create cutout pattern as per STEP # 1.
- B) Assemble the louver plate using the supplied hardware as shown in STEP # 2.
- C) Install the filter and brackets using the supplied hardware as shown in STEP # 3.
- D) Place UL/CSA label next to louver kit.

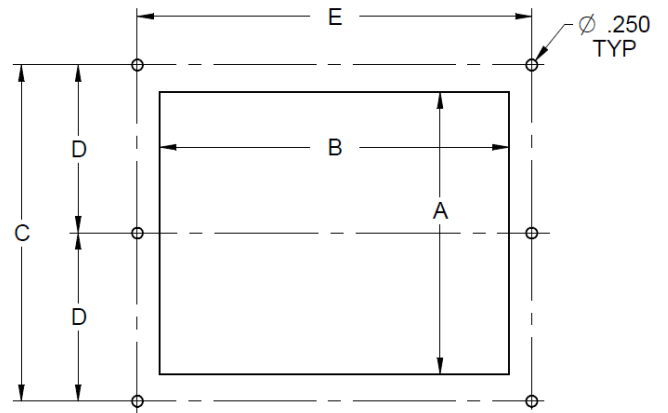

STEP # 1
(CUTOUT DETAIL)

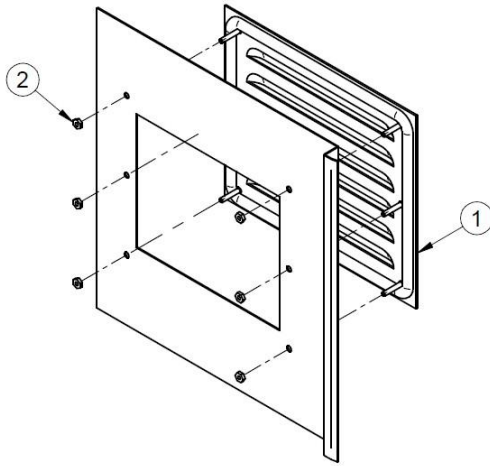

STEP # 2
(LOUVER PLATE INSTALLATION)

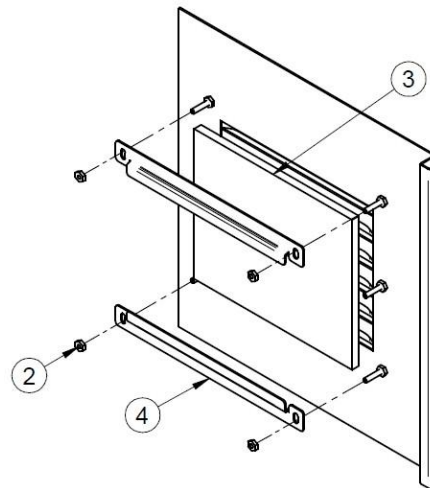

STEP # 3
(FILTER/BRACKET INSTALLATION)

Part	A	B	C	D	E
1481L3R56GY	2.88	3.75	3.75	N/A	4.75

ITEM	QTY	Description
1	1	Louver Plate
2	8 or 10	10-32 Kep Nuts
3	1	Filter
4	2	Filter Brackets
5	1	UL/CSA Label

Tools

- Cutting tool
- Drill, use 0.25" (6.4mm)
- Socket set



AGS Head Office

Tel: (727) 608-4375

Fax: (727) 538-4237

info@americangassafety.com