

Merlin Utility Control



Key Features

- Automatic control over utility.
- Clear LED status display.
- Built-in connectivity to existing BAS and fire alarm.
- Fascia mounted EM stop.
- Key lock for authorization control.
- Remote EPO buttons.

Overview

The Merlin CT500 utility control panel gives the user complete automatic control over the chosen utility supply within the room whilst providing a convenient connection centre for additional systems. Utilizing a solenoid valve, or Electrical Contactor the Merlin CT500 provides a keyed authority over the chosen utility supplies. The emergency knock off button is shrouded to ensure no accidental shutdowns occur.

All the Merlin utility controls come with clearly labelled PCB boards to ensure easy installation. Built in connectivity to existing BAS systems and inputs for existing fire alarms make the unit perfect for renovation projects as well as new build. Dip switches on the reverse side of the fascia panel allow for onsite adjustments on how the unit communicates with the buildings BMS / BAS system.

Application

- K-12 and Higher Ed Science Classrooms.
- Machine Shop Tool Control.
- Kitchen Gas Control
- Factory Machine Control.
- Electrical Receptacle Control.
- Decorative gas powered fire pits.
- Gas BBQ's installations.
- Commercial industrial spaces.
- Drug Test Laboratory.



Gas Safety Systems

American Gas Safety, LLC. 4500 140th Ave N. Suite 101. Clearwater, FL 33672 T.(727) 608-4375 F.(727) 538-4237 www.americangassafety.com

Utility Control

Technical Specifications

Power Supply	110-120vac, 50/60HZ
Protection	Overvoltage, overcurrent, surge protection (3amp)
Enclosure	Wall mounted Fully UL certified enclosure. Flush Mount kit available.
Dimensions	W 7.5in x H 5.5in x D 5.2in
Control Signal Output	110-120vac, 50/60HZ
BAS Output	N/C COM N/O - Max 1A @ 120vac
EM Stop Input	Volt Free*
Fire Alarm Input	Volt Free*
Adjustable BAS Signal Output	Alarm "on" or Gas "on" / Gas "off"

*Volt Free. Do Not connect any device which generates a separate source of voltage on this circuit. Any voltage applied to these connections will damage the microcontroller.

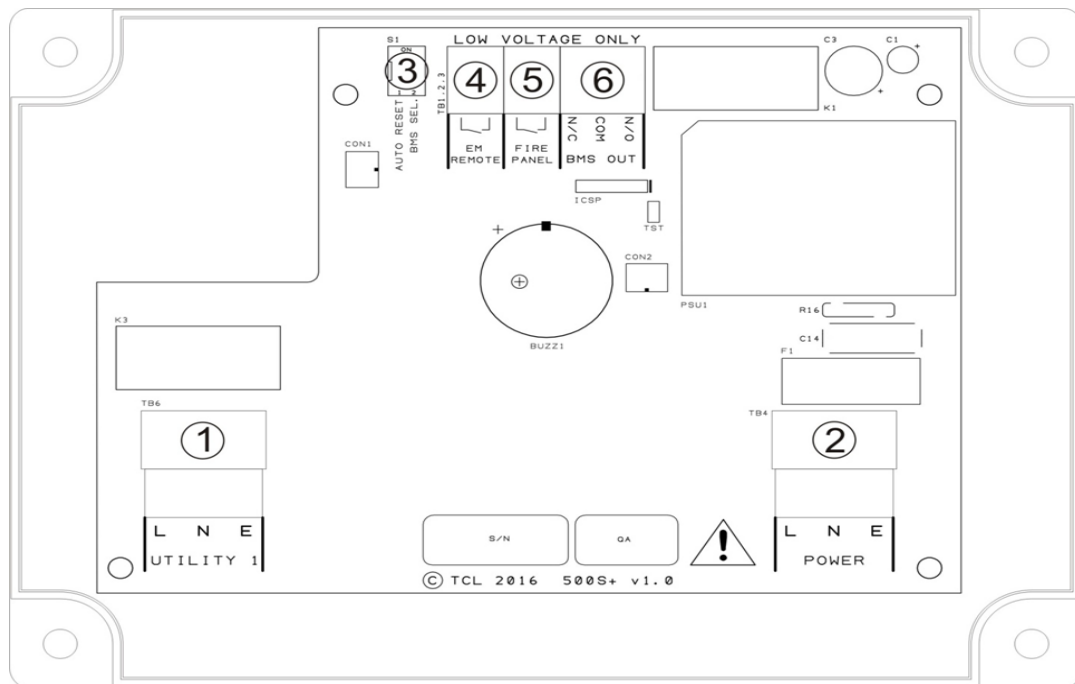

- 1) UTILITY 1 Power Output, 110-120AC, 50-60Hz.
- 2) Mains Input 110-120VAC, 50-60HZ.
- 3) Auto Reset & BMS Selection
- 4) Remote EM Stop buttons (purchased separately). **VOLT FREE INPUT**
- 5) Fire panel (Supplied by others). **VOLT FREE INPUT**
- 6) BMS output contacts. Normally Closed, Common and Normally Open

Gas Safety Systems

American Gas Safety, LLC. 4500 140th Ave N. Suite 101. Clearwater, FL 33672 T.(727) 608-4375 F.(727) 538-4237 www.americangassafety.com

Utility Control